



HR-1200



- Body components are alloy steel - Quenched & Tempered.
- Rated at 100% of Working Load Limit for angles up to 90 degrees.
- Each product is stamped with a Product Identification Code (PIC) for material traceability, along with a Working Load Limit, and the name Crosby or "CG."
- Hoist ring body is furnished with a yellow chromate finish for improved corrosion resistance.
- Utilize standard Crosby Red Pin® Shackles to connect to wire rope or synthetic slings (sold separately).
- Multiple bolt lengths available to meet specific application requirements.
- Individually Proof Tested to 2-1/2 times Working Load Limit.

LIFTING POINTS

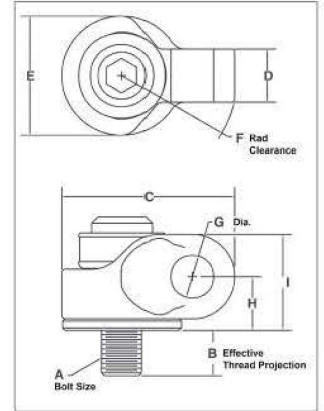

HR-1200 UNC Side Pull Hoist Rings

| Weight Each (kg) | Working Load Limit (kg) | Stock No. | Hoist Ring Bolt Torque (Nm) | Bolt Size A (in) | Eff. Thread Proj. (mm) B | Dimensions (mm) | | | | | | Recommended Shackles | | | | |
|------------------|-------------------------|-----------|-----------------------------|------------------|--------------------------|-----------------|------|------|------|--------|------|----------------------|---|------------------|--------------------|------------|
| | | | | | | C | D | E | F | Dia. G | H | I | Shackles 209, 210, 213, 215, 2130, 2150 | | Web Shackles S-281 | |
| | | | | | | | | | | | | | Nominal Size (in) | WLL (t) | Web Size (mm) | WLL (t) |
| .16 | 290 | 1067700 | 10 | 5/16-18x1.50 | 15.0 | 49.0 | 18.3 | 25.4 | 39.6 | 20.3 | 21.6 | 36.3 | 1/2, 5/8 | 2, 3-1/4 | 50 | 2.95 |
| .16 | 360 | 1067704 | 16 | 3/8-16x1.50 | 15.0 | 49.0 | 18.3 | 25.4 | 39.6 | 20.3 | 21.6 | 36.3 | 1/2, 5/8 | 2, 3-1/4 | 50 | 2.95 |
| .64 | 900 | 1067708 | 38 | 1/2-13x2.00 | 18.0 | 75.4 | 24.6 | 50.8 | 54.1 | 23.6 | 27.2 | 45.5 | 5/8, 3/4 | 3-1/4, 4-3/4 | 50, 35 | 2.95, 4.08 |
| .64 | 900 | 1067712 | 38 | 1/2-13x2.50 | 30.7 | 75.4 | 24.6 | 50.8 | 54.1 | 23.6 | 27.2 | 45.5 | 5/8, 3/4 | 3-1/4, 4-3/4 | 50, 35 | 2.95, 4.08 |
| .68 | 1360 | 1067716 | 81 | 5/8-11x2.00 | 18.0 | 75.4 | 24.6 | 50.8 | 54.1 | 23.6 | 27.2 | 45.5 | 5/8, 3/4 | 3-1/4, 4-3/4 | 50, 35 | 2.95, 4.08 |
| .68 | 1360 | 1067720 | 81 | 5/8-11x2.75 | 37.1 | 75.4 | 24.6 | 50.8 | 54.1 | 23.6 | 27.2 | 45.5 | 5/8, 3/4 | 3-1/4, 4-3/4 | 50, 35 | 2.95, 4.08 |
| 2.04 | 2260 | 1067724 | 136 | 3/4-10x2.75 | 22.9 | 110 | 34.0 | 76.2 | 76.2 | 27.2 | 34.3 | 61.5 | 7/8 | 6-1/2 | 50 | 5.67 |
| 2.09 | 2260 | 1067728 | 136 | 3/4-10x3.50 | 41.9 | 110 | 34.0 | 76.2 | 76.2 | 27.2 | 34.3 | 61.5 | 7/8 | 6-1/2 | 50 | 5.67 |
| 2.09 | 2940 | 1067732 | 217 | 7/8-9x2.75 | 22.9 | 110 | 34.0 | 76.2 | 76.2 | 27.2 | 34.3 | 61.5 | 7/8 | 6-1/2 | 50 | 5.67 |
| 2.18 | 2940 | 1067736 | 217 | 7/8-9x3.50 | 41.9 | 110 | 34.0 | 76.2 | 76.2 | 27.2 | 34.3 | 61.5 | 7/8 | 6-1/2 | 50 | 5.67 |
| 2.18 | 3620 | 1067740 | 312 | 1-8x3.00 | 29.2 | 110 | 34.0 | 76.2 | 76.2 | 27.2 | 34.3 | 61.5 | 7/8 | 6-1/2 | 50 | 5.67 |
| 2.27 | 3620 | 1067744 | 312 | 1-8x4.00 | 54.6 | 110 | 34.0 | 76.2 | 76.2 | 27.2 | 34.3 | 61.5 | 7/8 | 6-1/2 | 50 | 5.67 |
| 4.63 | 6350 | 1067748 | 637 | 1-1/4-7x4.5 | 56.4 | 142 | 39.9 | 95.3 | 99.3 | 37.3 | 48.8 | 86.9 | 1, 1-1/8, 1-1/4 | 8-1/2, 9-1/2, 12 | 75 | 7.70 |
| 10.7 | 7800 | 1067756 | 1085 | 1-1/2-6x6.5 | 75.7 | 186 | 52.3 | 121 | 132 | 53.6 | 61.2 | 109 | 1-3/8, 1-1/2, 1-3/4 | 13-1/2, 17, 25 | - | - |
| 11.5 | 13150 | 1067764 | 1491 | 2-4.5x6.5 | 75.7 | 186 | 52.3 | 121 | 132 | 53.6 | 61.2 | 109 | 1-3/8, 1-1/2, 1-3/4 | 13-1/2, 17, 25 | - | - |

5:1 Design Factor.

11

HR-1200M Metric Side Pull Hoist Rings

| Weight Each (kg) | Working Load Limit (kg) | Stock No. | Hoist Ring Bolt Torque (Nm) | Bolt Size A (mm) | Eff. Thread Proj. (mm) B | Dimensions (mm) | | | | | | Recommended Shackles | | | | |
|------------------|-------------------------|-----------|-----------------------------|------------------|--------------------------|-----------------|------|------|------|------|------|----------------------|---|------------------|--------------------|------------|
| | | | | | | C | D | E | F | G | H | I | Shackles 209, 210, 213, 215, 2130, 2150 | | Web Shackles S-281 | |
| | | | | | | | | | | | | | Nominal Size (in) | WLL (t) | Web Size (mm) | WLL (t) |
| .18 | 300 | 1067803 | 10 | M8x1.25x40 | 16.9 | 49.0 | 18.3 | 25.4 | 39.6 | 20.3 | 21.6 | 36.3 | 1/2, 5/8 | 2, 3-1/4 | 50 | 2.95 |
| .18 | 400 | 1067807 | 16 | M10x1.50x40 | 16.9 | 49.0 | 18.3 | 25.4 | 39.6 | 20.3 | 21.6 | 36.3 | 1/2, 5/8 | 2, 3-1/4 | 50 | 2.95 |
| .63 | 1000 | 1067811 | 38 | M12x1.75x50 | 17.2 | 75.4 | 24.6 | 50.8 | 54.1 | 23.6 | 27.2 | 45.5 | 5/8, 3/4 | 3-1/4, 4-3/4 | 50, 35 | 2.95, 4.08 |
| .68 | 1400 | 1067815 | 81 | M16x2.0x60 | 27.2 | 75.4 | 24.6 | 50.8 | 54.1 | 23.6 | 27.2 | 45.5 | 5/8, 3/4 | 3-1/4, 4-3/4 | 50, 35 | 2.95, 4.08 |
| 2.0 | 2250 | 1067823 | 136 | M20x2.5x75 | 28.1 | 110 | 34.0 | 76.2 | 76.2 | 27.2 | 34.4 | 61.5 | 7/8 | 6-1/2 | 50 | 5.67 |
| 2.2 | 3500 | 1067827 | 312 | M24x3.0x80 | 33.1 | 110 | 34.0 | 76.2 | 76.2 | 27.2 | 34.4 | 61.5 | 7/8 | 6-1/2 | 50 | 5.67 |
| 4.5 | 6250 | 1067831 | 637 | M30x3.5x120 | 65.1 | 142 | 39.9 | 95.3 | 99.3 | 37.3 | 48.8 | 86.9 | 1, 1-1/8, 1-1/4 | 8-1/2, 9-1/2, 12 | 75 | 7.70 |
| 10.4 | 7750 | 1067835 | 1005 | M36x4.0x150 | 60.6 | 186 | 52.3 | 121 | 132 | 53.6 | 61.2 | 109 | 1-3/8, 1-1/2, 1-3/4 | 13-1/2, 17, 25 | - | - |
| 10.7 | 10000 | 1067839 | 1005 | M42x4.5x160 | 70.6 | 186 | 52.3 | 121 | 132 | 53.6 | 61.2 | 109 | 1-3/8, 1-1/2, 1-3/4 | 13-1/2, 17, 25 | - | - |
| 11.0 | 13000 | 1067843 | 1350 | M48x5.0x160 | 70.6 | 186 | 52.3 | 121 | 132 | 53.6 | 61.2 | 109 | 1-3/8, 1-1/2, 1-3/4 | 13-1/2, 17, 25 | - | - |

5:1 Design Factor.



APPLICATION AND WARNING INFORMATION SECTION 17

